

TYPE - RGD

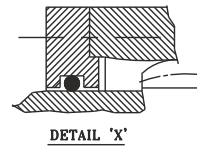
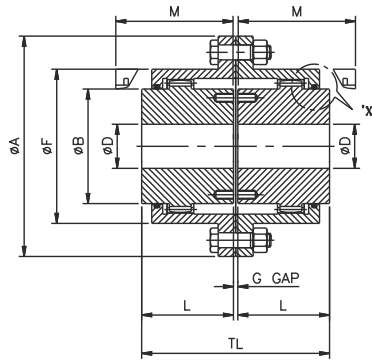

THIS COVERPLATE CONSTRUCTION FOR SIZES RGD-80 ONWARDS.

FULL FLEXIBLE TYPE RGD

Double Engagement Couplings: TYPE - RGD

Standard Double engagement couplings accommodate both angular and parallel misalignment or combination of both, as well as end float without imposing appreciable axial loads on adjacent bearings.

The exposed bolt design allows use of the either open end or socket wrenches, which makes it the preferred design for most industrial applications.

Ideal for all standard applications including fans, overhead cranes, conveyors, steel and paper mill equipments.

Special requirements like limited end float, electrical insulation, Mill motor, Slide, Spacer, Brake drum, Shear pin, Shrouded bolt designs are supplied.

Size	Coupling Rating		Maximum Speed rpm	Bore Dia ØD mm		Dimensions mm						Solid Hub		
	kW at 100 rpm	Rated Torque Nm		Min. Bore	Max. Bore	ØA	ØB	ØF	G	M	L	TL	Mass kg	M.I. (WR ²) kg-m ²
RGD-10	14	1337	8000	14	52	116	69	84	3	51	43	89	4.4	0.0052
RGD-15	30	2865	6500	22	65	152	86	107	3	61	50	103	9	0.0192
RGD-20	53	5061	5600	27	80	178	105	127	3	76	62	127	15	0.041
RGD-25	105	10027	5000	32	98	213	131	156	5	92	77	159	27	0.105
RGD-30	168	16043	4400	42	115	240	152	182	5	106	91	187	40	0.195
RGD-35	231	22059	3900	47	135	279	178	212	6	130	107	220	65	0.454
RGD-40	336	32086	3600	47	160	318	210	250	6	145	121	248	96	0.86
RGD-45	472	45073	3200	52	180	346	235	275	8	165	135	278	131	1.39
RGD-50	650	62070	2900	72	195	389	254	309	8	183	153	314	186	2.53
RGD-55	880	84034	2650	72	215	425	279	334	8	203	168	344	247	3.83
RGD-60	1205	115069	2450	77	235	457	305	366	8	228	188	384	299	5.21
RGD-70	1823	174084	2150	92	280	527	356	425	9	266	221	451	473	11
RGD-80	2639	252006	1750	95	285	590	385	485	10	300	249	508	682	20.72
RGD-90	3037	290012	1550	100	300	660	420	535	13	325	276	565	898	34.95
RGD-100	4100	391521	1450	120	330	711	470	595	13	355	305	623	1242	55.95
RGD-110	5300	506113	1395	130	381	775	533	68	13	387	334	681	1621	84.81
RGD-120	7200	687549	1300	180	432	838	572	715	13	415	356	725	2014	124.2
RGD-130	8100	773493	1075	190	482	911	630	812	19	463	410	839	2803	207.07
RGD-140	10400	993127	940	200	515	980	670	860	19	486	430	879	3316	277.64
RGD-150	12100	1155465	900	210	559	1029	725	908	19	518	450	919	3951	371.28

