

Wedgegard® Type DIN Spacer Manual Reset

DATASHEET Version April 2020 - in-lbs-ft

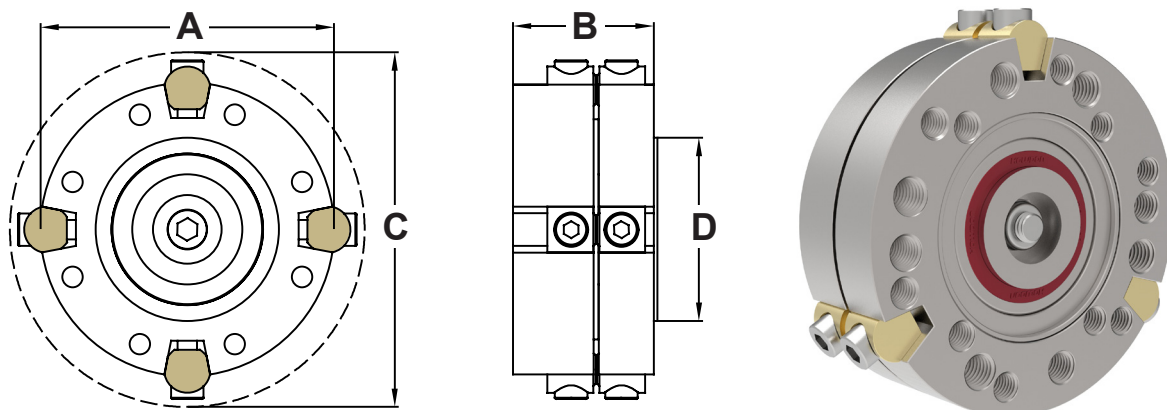

- Fits standard DIN UJ (Universal Joint) companion flanges.
- Release torque is adjustable by Wedgepin ratings.
- The maximum release torque is based on maximum Wedgepin capacity and not Universal Joint shaft capacity- Check your Universal.
- Joint shaft manufacturers max load rating.
- Adaptor Flange maybe required when fitting to PTO Gear Box Flange.
- Spigot diameters may change on higher rated Universal Joint shafts
- Sizes 150 and above are supplied with face keyways.
- When selecting high overloads always limit the release torque to 90% of Universal Joint shaft manufacturers full load rating.
- Non Standard units can be made to order.
- **Higher Release/Shear Torques may be available.**

Size - DIN		90	100	120	150	180	180	225	250	285	315	350	390	435
UJ Shaft Size		90	100	120	150	180	180	225	250	285	315	350	390	435
Max Release/ Shear Torque (in-lbs)	Brass	17949	17949	54582	68947	83312	141328	-	-	-	-	-	-	-
	Steel	24649	24649	74965	94694	114422	194105	530369	596670	689478	769037	1145059	1194845	1344200
Max Release/ Shear (ft-lbs)	Brass	1496	1496	4549	5746	6943	11777	-	-	-	-	-	-	-
	Steel	2054	2054	6247	7891	9535	16175	44198	49723	57457	64087	95422	99571	112017
Wedgeslot Quantity & Wedgepin Type		3 x W37	3 x W37	4 x W50	4 x W50	4 x W50	4 x W75	4 x W100	4 x W100	4 x W100	4 x W100	4 x W120	4 x W120	4 x W120
Pin Working Radius (PWR)		1.8504	1.8504	2.2476	2.8339	3.4299	3.1689	3.9370	4.4291	5.1181	5.7087	6.7913	7.0866	7.9724
Outside Diameter (A)		3.9370	3.9370	4.7244	5.9055	7.0866	7.0866	8.8583	9.8425	11.2205	12.4016	14.7638	15.3543	17.1260
Length (B)		1.4567	1.4173	2.2835	2.8740	2.8740	2.8740	3.2283	3.5039	4.5276	4.7244	5.9055	5.9055	7.6772
Clearance Diameter (C)		4.5276	4.5276	5.5118	7.0866	8.2677	8.2677	10.4331	11.4173	12.7953	14.1732	16.9291	17.7165	18.8976
Spigot Diameter (D)		1.8504	2.2441	2.9528	3.5433	4.3307	4.3307	4.1339	4.1339	5.7087	6.8898	8.6614	6.6929	7.4803
Bolt Fixing Quantity & Size		4 x M8	6 x M8	6 x M8	8 x M12	8 x M14	8 x M14	8 x M16	8 x M18	8 x M20	10 x M22	10 x M22	10 x M24	16 x M27
Bolt Fixing P.C.D.		2.9331	3.3071	3.9961	5.1181	6.1220	6.1220	7.7165	8.5827	9.6457	11.0236	12.2047	13.5827	15.1575

*All dimensions in Inches unless otherwise specified

Maximum Release/Shear Torques shown are for RED coded Wedgepins fitted.
Dimensions and specifications may change for improvement without notice.



Can't find the torque limiter you're looking for? Howdon offers a bespoke engineering design service.

Tel: +44 (0)1453 750814
Fax: +44 (0)1453 765320
www.howdon.co.uk
sales@howdon.co.uk

