

Wedgegard® Type DIN Spacer Manual Reset

DATASHEET Version 11/2023 - in-lbs-ft

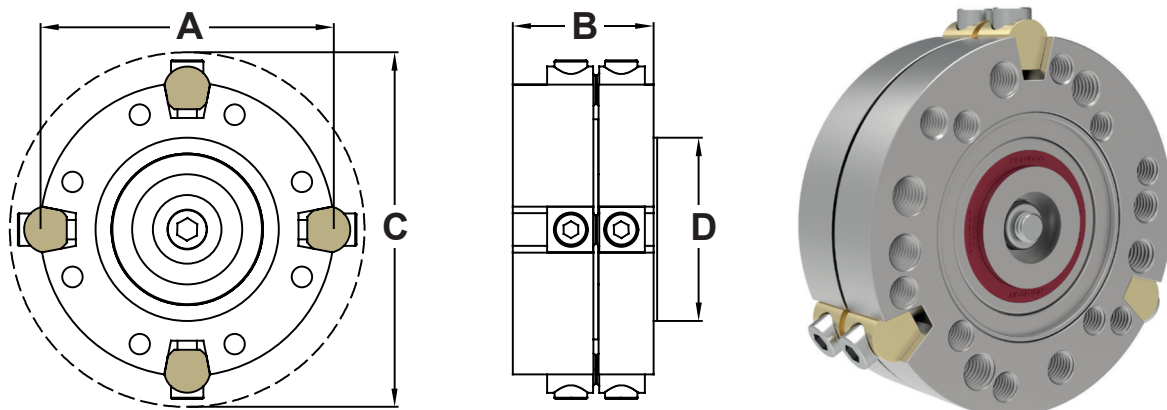

- Fits standard DIN UJ (Universal Joint) companion flanges.
- Release torque is adjustable by Wedgepin ratings.
- The maximum release torque is based on maximum Wedgepin capacity and not Universal Joint shaft capacity- Check your Universal.
- Joint shaft manufacturers max load rating.
- Adaptor Flange maybe required when fitting to PTO Gear Box Flange.
- Spigot diameters may change on higher rated Universal Joint shafts
- Sizes 150 and above are supplied with face keyways.
- When selecting high overloads always limit the release torque to 90% of Universal Joint shaft manufacturers full load rating.
- Non Standard units can be made to order.
- **Higher Release/Shear Torques may be available.**

Size - DIN		90	100	120	150	180	180	225	250	285	315	350	390	435
UJ Shaft Size		90	100	120	150	180	180	225	250	285	315	350	390	435
Max Release/ Shear Torque (In-lbs)	Brass	17946	17946	54586	68951	83316	141329	-	-	-	-	-	-	-
	Steel	24647	24647	74968	94696	114424	194109	530372	596669	689484	945919	1145065	1194851	1344207
Max Release/ Shear (ft-lbs)	Brass	1495	1496	4549	5746	6943	11777	-	-	-	-	-	-	-
	Steel	2054	2054	6247	7891	9535	16176	44198	49722	57457	78827	95422	99571	112017
Wedgeslot Quantity & Wedgepin Type		3 x W37	3 x W37	4 x W50	4 x W50	4 x W50	4 x W75	4 x W100	4 x W100	4 x W100	4 x W120	4 x W120	4 x W120	4 x W120
Pin Working Radius (PWR)		1.850	1.850	2.248	2.834	3.430	3.169	3.937	4.429	5.118	5.610	6.791	7.087	7.972
Outside Diameter (A)		3.937	3.937	4.724	5.906	7.087	7.087	8.858	9.843	11.220	12.402	14.764	15.354	17.126
Length (B)		1.457	1.417	2.283	2.874	2.616	2.616	3.228	3.504	4.528	5.354	5.906	5.906	7.677
Clearance Diameter (C)		4.528	4.528	5.512	7.087	8.268	8.268	10.433	11.417	12.795	14.173	16.929	17.717	18.898
Spigot Diameter (D)		1.850	2.244	2.953	3.543	4.331	4.331	4.134	4.134	5.709	6.890	8.661	6.693	7.480
Bolt Fixing Quantity & Size		4 x M8	6 x M8	8 x M10	8 x M12	8 x M14	8 x M14 8 x M16	8 x M16	8 x M18	8 x M20	10 x M22	10 x M22	10 x M24	16 x M27
Bolt Fixing P.C.D.		2.933	3.307	3.996	5.118	6.122	6.122	7.717	8.583	9.646	11.024	12.205	13.583	15.157

*All dimensions in Inches unless otherwise specified.
Inch dimensions are direct conversion from (mm).
Dimensions and specifications may change for
improvement without notice.

Maximum Release / Shear Torques shown are for a FULL complement of RED coded
Wedgepins fitted – for the complete torque range see DIN Spacer Torque Tables.
All figures are shown as a guide and should be considered approximate.
Contact Howdon for more detailed figures for your specific requirements.

This document is an intellectual property of Howdon Power Transmission Ltd and is subject to copyright.



Can't find the torque
limiter you're looking for?
Howdon offers a bespoke
engineering design service.

Tel: +44 (0)1453 750814
Fax: +44 (0)1453 765320
www.howdon.co.uk
sales@howdon.co.uk

